

## DS-2CE56D5T-AVPIR3

### HD1080p TurboHD Outdoor Vandal Resistant IR Dome Camera

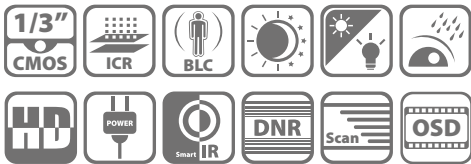

#### Key Features

- HD1080p Video Output
- HD-TVl Technology
- True Day/Night
- 2.8 mm to 12 mm Varifocal Lens
- OSD Menu, 3D DNR, Smart IR
- Up to 40 Meters IR Range
- IP66 Weatherproof and Vandal Resistant
- Up-the-Coax (via Coaxial Cable)
- 120 dB Wide Dynamic Range

#### Dimensions

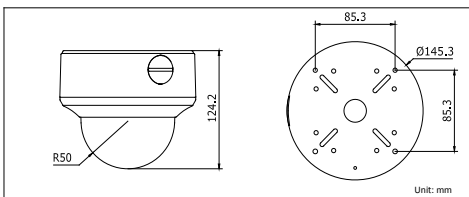

#### Accessories



Video Balun  
DS-1H18

#### Order Models

DS-2CE56D5T-AVPIR3

DS-2CE56D5T-AVPIR3	
<b>Camera</b>	
Image Sensor	1/3" progressive scan CMOS
Signal System	PAL/NTSC
Effective Pixels	1920 x 1080
Minimum Illumination	0.014 lux @ (f/1.4, AGC on), 0 lux with IR
Shutter Speed	1/25 (1/30) s to 1/50,000 s
Lens	2.8 mm to 12 mm @ f/1.4
	Angle of view: 92° to 32°
Lens Mount	φ14
Angle Adjustment	Pan: 0° to 355°, tilt: 0° to 80°, rotation: ± 90°
Day/Night	ICR
Wide Dynamic Range	120 dB
Synchronization	Internal synchronization
Video Frame Rate	1080p @ 25 fps/1080p @ 30 fps
HD Video Output	1 analog HD output
CVBS Output	1 Vp-p composite output (75 Ω/BNC)
S/N Ratio	More than 52 dB
<b>Menu</b>	
Scene	Indoor, Outdoor, Indoor1, LOW-LIGHT
Camera ID	On/off (15 characters, position programmable)
AGC	Supported
D/N Mode	Color/BW/EXT
White Balance	ATW, AWC-SET, indoor, outdoor, manual
Privacy Mask	On/off, maximum 8 zones
Motion Detection	On/off, maximum 4 zones
BLC	Supported
Anti-Flicker	On/off
Functions	Eclipse, digital noise reduction, digital zoom (62x), slow shutter, mirror, defog, defect pixel correction, SMART D-ZOOM
<b>General</b>	
Working Temperature/Humidity	-30° C to 60° C (-22° F to 140° F) Humidity 90% or less (non-condensing)
Power Supply	12 VDC, 24 VAC
Power Consumption	12 VDC: maximum 4 W; 24 VAC: maximum 5 W
Weather Proof Ratings	IP66
IR Range	Up to 40 meters
Impact Protection	IEC60068-2-75 test, Eh, 20J; EN50102, up to IK10.
Communication	Up-the-coax (need UTC controller)
Dimensions	φ145.3 mm × 124.2 mm (φ5.72" × 4.89")
Weight	880 g (1.95 lb)